

# TRACTION BATTERY

## 3PzB195G (2V195Ah)

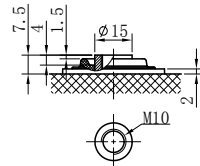
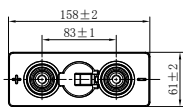
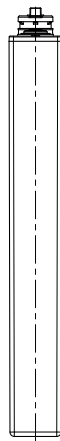
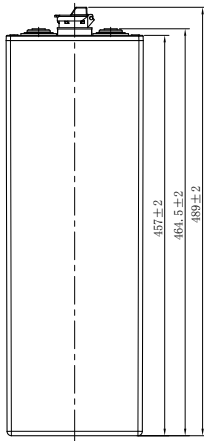

## CHARACTERISTICS

Item	Specifications	
Rated Voltage	2V	
Capacity@25°C (86°F)	C <sub>5</sub> , 1.70V/cell	195Ah
Dimension	Length	61mm (2.40inches)
	Width	158mm (6.22inches)
	Container Height	457mm (18.0inches)
	Total Height	489mm (19.3inches)
Approx Weight	Without Electrolyte	9.3kg (20.5lbs)
	With Electrolyte	12kg (26.5lbs)
Terminal	M10	
Container Material	PP	
Max. Discharge Current (5s)	8C <sub>5</sub>	
Operating Temp. Range	Discharge	-15~55°C(5~131°F)
	Charge	0~50°C(32~122°F)
	Storage	5~40°C(41~104°F)
Cycle life	≥1200 cycles	
Cycle Use	Initial Charging Current	less than 0.14C <sub>5</sub>
	Voltage	2.60V-2.65V at 25°C(77°F)
	Temp. Coefficient	-5mV/°C
Capacity affected by Temperature	40°C(104°F)	103%
	30°C(86°F)	100%
	0°C(32°F)	86%
Self Discharge	Less than 8% C <sub>5</sub> after storing 28 days at 20°C, and then a freshening charge is required.	
	For higher temperature, the time interval will be shorter.	

## APPLICATIONS

- Forklift
- Traction vehicle
- Transportation vehicle
- Tram
- Bus
- Gymnastic and recreation location

## GENERAL FEATURES

- Nonwoven protective gauntlet, better elastic property, less pore size, less electrical resistance and higher air permeability
- Flexible, fully isolated connector prevents any creeping current
- Flip top plugs with special electrolyte level indication
- Automatic refilling plugs are also available (according request)
- Imported microporous catercome rseparator with advanced quality provides higher porosity and lower electrical resistance
- Containers and lids are made of polypropylene (PP)The impact resistance is very good
- Patented terminal sealing construction fully prevents plate growth and electrolyte leakage

# TRACTION BATTERY

## 3PzB195G (2V195Ah)



### Discharge Characteristics



### Electrolyte Density in Relation to Voltage

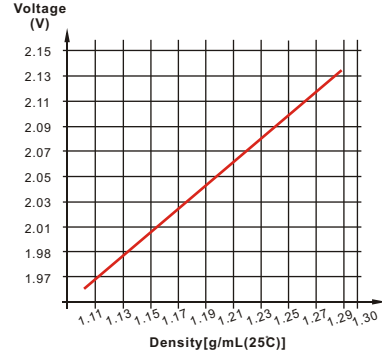

### Electrolyte Density in Relation to Capacity

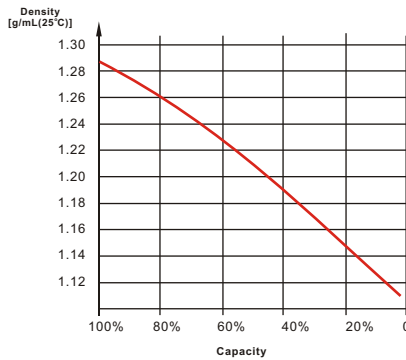

### Temperature in Relation to Battery Capacity

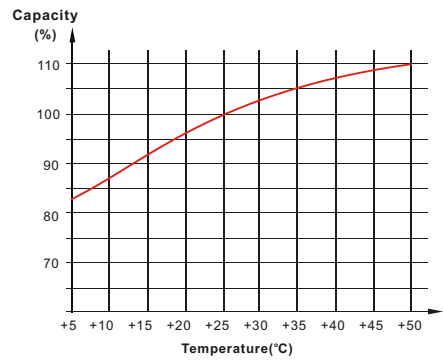

### Discharge Characteristics



### Cycle Life in Relation to Depth of Discharge



Leoch International Technology Ltd.  
[www.leoch.com](http://www.leoch.com)

Leoch Batteries Pte Ltd  
[www.leoch.sg](http://www.leoch.sg)

Leoch Battery Corporation  
[www.leoch.us](http://www.leoch.us)

Leoch Europe S.A.  
[www.leoch.eu](http://www.leoch.eu)