

HEAVY DUTY AGM DUAL PURPOSE BATTERY

LPM12-210HD (12V210Ah)



CHARACTERISTICS

Item	Specifications	
Nominal Voltage	12V	
Nominal Capacity (20HR)	210Ah	
Reserve Capacity	450min	
Cold Cranking Amps@0°F (-18°C)	1200A	
Dimension	Length	517mm (20.4inches)
	Width	272mm (10.7inches)
	Container Height	218mm (8.58inches)
	Total Height (with Terminal)	238mm (9.37inches)
Approx Weight	62.0kg (136.7lbs)	
Terminal	5	
Cell layout	3	
Hold-Down	B0	
Case	Black-PP Material	
Cover	Black-PP Material	
Handle	TS8	

APPLICATIONS

- Parking air-conditioner
- Commercial vehicle start
- Engine start

GENERAL FEATURES

- Superior deep cycle performance
- Excellent start ability
- Super capacity reach 330Ah
- VRLA and maintenance-free design
- Excellent vibration resistance – EN V4
- High charge acceptance, fast recharge
- OE quality certification

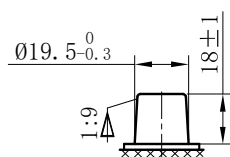

POS

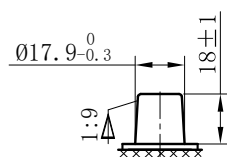

NEG

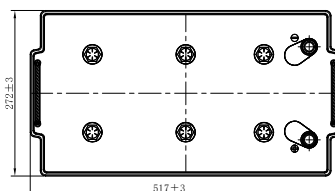
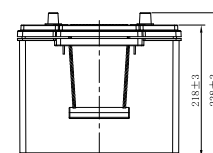
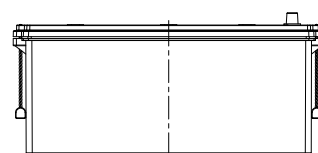

*Values are subject to variation of +/- 5% in normal manufacturing processes.

Leoch International Technology Ltd.
www.leoch.com

Leoch Batteries Pte Ltd
www.leoch.sg

Leoch Battery Corporation
www.leochamericas.com

Leoch Europe S.A.
www.leoch.eu