

# AGM START-STOP BATTERY

AGM-B21R (12V40Ah)



## CHARACTERISTICS

Item	Specifications
Nominal Voltage	12V
Nominal Capacity (20HR)	40Ah
Reserve Capacity	61min
Cold Cranking Amps@0°F (-18°C)	330A
Dimension	Length 200.5mm (7.89inches)
	Width 134.5mm (5.30inches)
	Height 224mm (8.82inches)
Approx Weight	12.3kg (27.1lbs)
Terminal	1
Cell layout	1
Hold-Down	B0
Case	Black-PP Material
Cover	Black-PP Material
Handle	TS1

## APPLICATIONS

- Car with start-stop system
- EV/HEV
- Engine start

## GENERAL FEATURES

- Maximum CCA and life
- Valve regulated technology
- Advanced Absorbed Glass Mat (AGM) technology
- Top-level safety - absolutely no free acid
- 2x Faster Charge Acceptance than conventional starter batteries
- 3x higher cycle life than conventional starter batteries
- Suit for working in partial state of charge operations (PSoC)
- OE quality certification

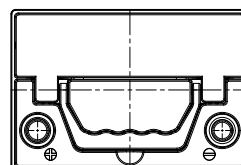
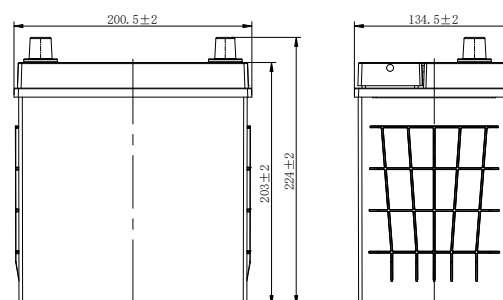
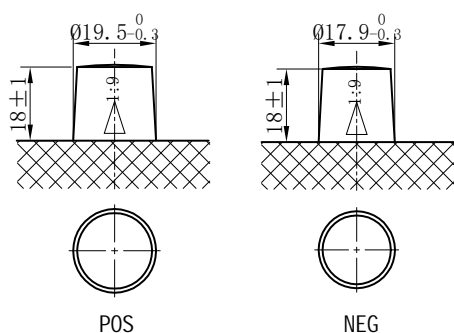

\*Values are subject to variation of +/- 5% in normal manufacturing processes.

Leoch International Technology Ltd.  
www.leoch.com

Leoch Batteries Pte Ltd  
www.leoch.sg

Leoch Battery Corporation  
www.leochamericas.com

Leoch Europe S.A.  
www.leoch.eu